



- Panoramic sea views
- 3 double bedrooms
- Private development
- Garage
- Share of Freehold

**PRICE GUIDE**  
**£760,000**

## 28 Branksome Towers, Branksome Park, Poole, Dorset BH13 6JU

A rare opportunity to purchase this spacious three double bedroom first floor apartment situated in the very sought after 'Branksome Towers' development overlooking Branksome Chine Beach.

The property boasts panoramic sea and beach views. Within the grounds there is a private walkway which will take you to Branksome Chine beach in a couple of moments.

The property has been a very happy home for the owner for over 30 years but would now benefit from modernisation throughout.

The development is situated in a private road making it a very quiet and peaceful place to live. Also conveyed with the apartment is a garage and ample visitors parking. There is a large entrance hall which the primary rooms lead off from, including the generous sized living room that encompasses tremendous sea views.

This property will be very popular due to its special location and its stunning views and will give an incoming purchaser the opportunity to put their own stamp on it to create a stunning main home or weekend retreat.

### Summary of Accommodation

Spacious entrance hall

Large living room benefitting from stunning views and access onto a private balcony

Kitchen which could be opened up to make an open plan living/kitchen area

Master bedroom with fitted wardrobes, en-suite bathroom and access onto balcony.

Family bathroom

Garage

Private walkway to Branksome Chine beach

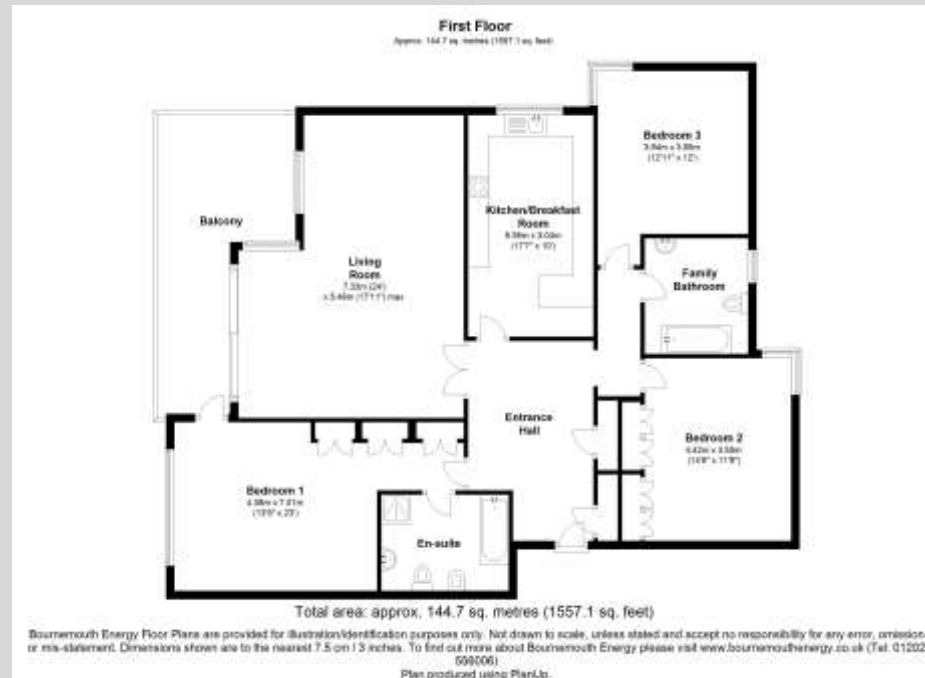

**Viewing** Strictly by appointment through Lloyds.

VIEWING 7 DAYS A WEEK Ref: 3157

These particulars are prepared with all due care but their accuracy cannot be guaranteed nor should details contained herein form part of any contract. We would advise that you independently verify these details before signing any contact.

Lloyds Property Group

32 Haven Road, Canford Cliffs, Poole, Dorset BH13 7LP 01202 701800  
264 Sandbanks Road, Lilliput, Poole, Dorset BH14 8HA 01202 708044

**LLOYDS**  
PROPERTY GROUP